

[www.scag.ca.gov/rtp2012](http://www.scag.ca.gov/rtp2012)

## 2012-2035 Regional Transportation Plan/ Sustainable Communities Strategy (RTP/SCS)

After more than two years of extensive collaboration with stakeholders from across Southern California, the Southern California Association of Governments (SCAG) proudly presents the 2012-2035 Regional Transportation Plan/Sustainable Communities Strategy (RTP/SCS). The RTP/SCS was developed with input from hundreds of Southern Californians and embodies our collective vision for the region's future.

### WHAT IS THE REGIONAL TRANSPORTATION PLAN?

The RTP is a long-range transportation plan that provides a vision for regional transportation investments over a period of 20 years or more. Using growth forecasts and economic trends, the RTP considers the role of transportation in a more holistic light, including economic factors, environmental issues and quality-of-life goals. The RTP provides an opportunity to identify transportation strategies today that address our mobility needs for the future.

The RTP is updated every four years to reflect changes in economic trends, State and Federal requirements, progress made on projects, and adjustments for population and jobs. Transportation projects must be included in the RTP in order to qualify for Federal and State funding. SCAG's Regional Council will consider adoption of the 2012-2035 RTP/SCS on April 4, 2012.

### WHAT IS THE SUSTAINABLE COMMUNITIES STRATEGY?

The SCS is a new element of the RTP that demonstrates the integration of land use, transportation strategies, and transportation investments within the Plan. This new requirement was put in place by the passage of SB 375, with the goal of ensuring that the SCAG region can meet its regional greenhouse gas reduction targets set by the California Air Resources Board (ARB).

The SCS exceeds the targets issued by ARB (8% reduction by 2020 and 13% reduction by 2035), resulting in a 9% reduction by 2020 and 16% by 2035.

## RTP FOCUS AREAS

- [Active Transportation](#)
- [Aviation](#)
- [Environmental Mitigation](#)
- [Goods Movement](#)
- [Growth Forecast](#)
- [Highways and Arterials](#)
- [Land Use](#)
- [Passenger Rail](#)
- [Transit](#)
- [Transportation Demand Management](#)
- [Transportation Finance](#)
- [Transportation Safety and Security](#)

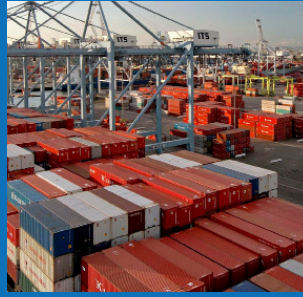
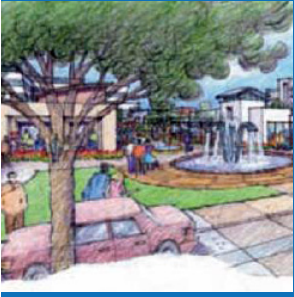

## SUSTAINABLE COMMUNITIES STRATEGY DEVELOPMENT

Developing the SCS required meaningful collaboration with local governments and stakeholders to identify land-use opportunities around the region to address the needs of our growing population and ensure compliance with State and Federal requirements.

The SCS is a comprehensive regional vision built and implemented from the local level. Some of the key land-use policies and strategies that the SCS utilizes to achieve the goals of SB 375 are:

- Focusing growth in existing and emerging centers and along major transportation corridors
- Creating significant areas of mixed-use development and walkable communities
- Targeting growth around existing and planned transit stations
- Preserving existing open space and stable residential areas

## WHAT IS SCAG'S ROLE IN DEVELOPING THE RTP/SCS?

As the Regional Transportation Planning Agency (RTPA) and Metropolitan Planning Organization (MPO), SCAG was the lead agency to facilitate the development of the RTP/SCS. However, in a huge and diverse region containing six counties (Imperial, Los Angeles, Orange, Riverside, San Bernardino, and Ventura) and 191 cities, SCAG understands the importance of input and consensus, and utilized a collaborative process to create the RTP/SCS. Throughout the development of the RTP/SCS, SCAG sought the opinion and feedback of interested parties, including county transportation commissions, subregions, local governments, as well as several state and federal agencies, environmental and business communities, tribal governments, non-profit organizations, and the general public. The end result of this collaborative process is a Plan that charts a course laid out by none other than Southern Californians themselves, and that will lead us towards a more mobile, sustainable, and prosperous future.

## FOR MORE INFORMATION

Please visit the SCAG website at [www.scag.ca.gov/rtp2012](http://www.scag.ca.gov/rtp2012) or contact **Ryan Kuo** at (213) 236-1813 or via email at [kuo@scag.ca.gov](mailto:kuo@scag.ca.gov) or **Arlene Granadosin** at (213) 236-1865 or via email at [granados@scag.ca.gov](mailto:granados@scag.ca.gov).

Images courtesy of City of Anaheim, Los Angeles World Airports, Metro © 2012 LACMTA, Orange County Transportation Authority, Port of Long Beach, and San Bernardino Associated Governments.



SOUTHERN CALIFORNIA  
ASSOCIATION of GOVERNMENTS

818 West 7th Street, 12<sup>th</sup> Floor  
Los Angeles, CA 90017  
Tel: (213) 236-1800  
Fax: (213) 236-1963  
[www.scag.ca.gov](http://www.scag.ca.gov)